

Penta Wrench

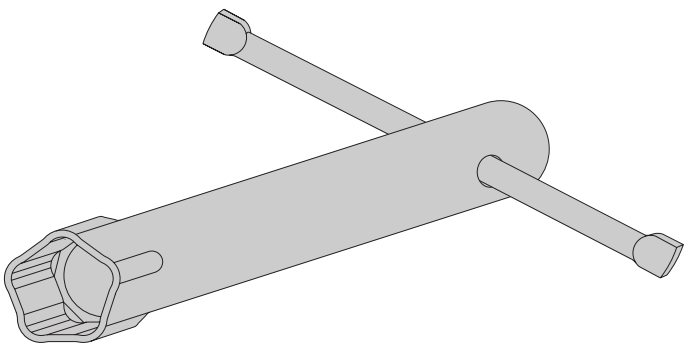
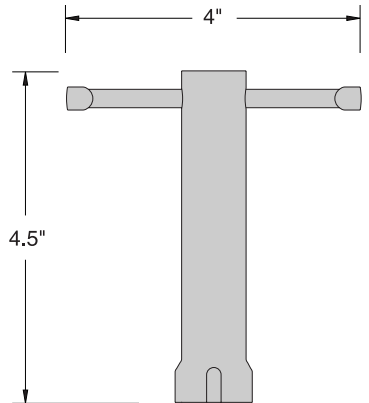

Penta

Hex

| Catalog Number | Description | Material |
|----------------|-----------------------|---|
| 6201-PW10 | "T" Type Penta Wrench | 0.0625 Wall Light Galv. Mild Steel with 0.25" Dia. Stainless Steel T-Handle |
| 6201-HW10 | "T" Type Hex Wrench | 0.0625 Wall Light Galv. Mild Steel with 0.25" Dia. Stainless Steel T-Handle |

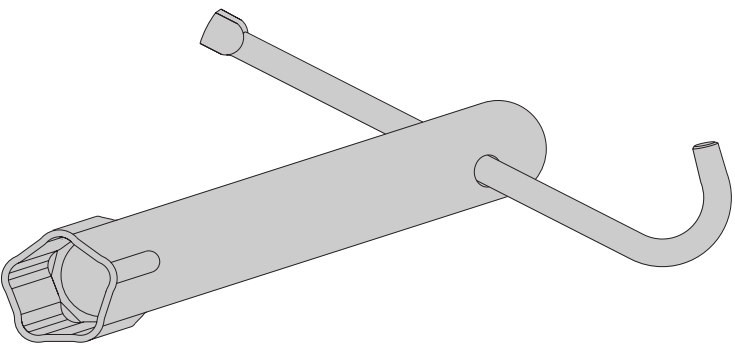
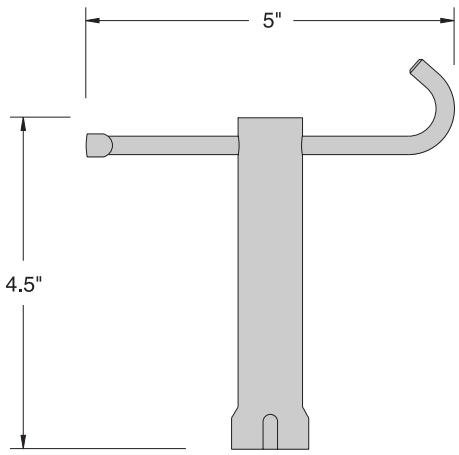

Penta

| Catalog Number | Description | Material |
|----------------|--------------------------------------|---|
| 6201-PW15 | "T" Type Penta Wrench with Lift Hook | 0.0625 Wall Light Galv. Mild Steel with 0.25" Dia. Stainless Steel T-Handle |



Penta Wrench

Descriptive
Bulletin
6201
Page 2 2015

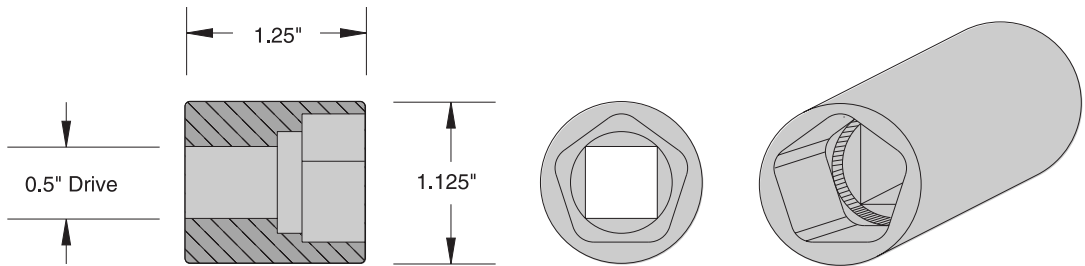

| Catalog Number | Description | Material |
|----------------|--------------|---|
| 6201-PW20 | Penta Socket | High Carbon Alloy Steel Nickel Chromed Plated |